



**H&H INC.**  
Healthcare Infra Products

# INDEX

About us	01
Our Clients	02
Saral - Bed Head Panels	03
Aura - Bed Head Panels	04
Camo - Bed Head Panels	05
Magnus - Bed Head Panels	06
Colour Range - Bed Head Panels	07
Wall Unit - SisCall	08
Patient Remote - SisCall	09
Toilet Call Unit - SisCall	10
Door Light - SisCall	11
Nursing Station Display - SisCall	12
Software and App - SisCall	13
Key Features - SisCall	14
System Architecture	15
"I-Traack™" - Cubicle Hospital Tracks	16
Urban Fresh™ - Cubicle Hospital Curtains	17
Urban Safe™ - Cubicle Hospital Curtains	18
"Wall Shield" - Wall Protection System	19
Pneumatic Tube System	22

## About Us

Established in 2014, H&H Inc. is a well-managed company located in Surat(Gujarat), known for being a reputable manufacturer and supplier of “Healthcare Infrastructure Products,” providing cost-effective solutions. At H&H Inc., we have conducted thorough research to understand the diverse needs of consumers. Our unique product ranges are the outcome of years of in-depth exploration in the field. All our processes are designed to enhance customer satisfaction significantly.

Our cutting-edge manufacturing procedures and strict adherence to quality checks set us apart. We continuously adapt to changing trends and cater to the preferences of our clients. Introducing innovation and technologically advanced solutions is a consistent practice at H&H Inc., making us pioneers in the industry. Our products are not only user-friendly but also uphold high standards of quality, reliability, and efficiency. This commitment has positioned us as leaders in the healthcare infrastructure sector.

Project Completed

**250+**

Curtains Installed

**2,000,000+ Sq.Ft.**

Bed Head Panel Installed

**5000+ meters**

Total Beds Covered

**20,000+**

### Manufacturing Products:

- Bed Head Panels (BHP)
- “Siscall™” – Nurse Call System
- “I-Traack™” – Cubicle hospital Tracks
- “Urban-Fresh™”
- “Urban-Safe™”
- “Wall-Shield™” – Wall Protection System

↔ Hospital Curtains

### Partnered Product:

- PTS – Pneumatic Tube System

# Our Clients

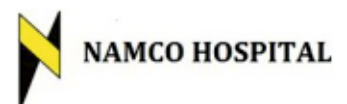



# Bed Head Panels

## Saral

The "Saral" series is a versatile bed head panel for healthcare settings, offering both horizontal and vertical use. It prioritizes essential functionalities like medical equipment provisions, power outlets, lighting, and other crucial elements for effective patient care.



### Bed Head Panel Configuration

- **Material:** Extruded Aluminum Alloy (T6 – 6063)
- **Dimensions:** Length – Customizable  
Width – 200mm, Depth – 65mm.
- **Standard Length:** 1000mm, 1200mm, 1500mm, 1800mm & 2000mm.
- **Orientation:** Horizontal or Vertical.

### Features

- Provision for Both ABS & Aluminum End Caps.
- Disinfection & Corrosion Resistant

### Exploded View

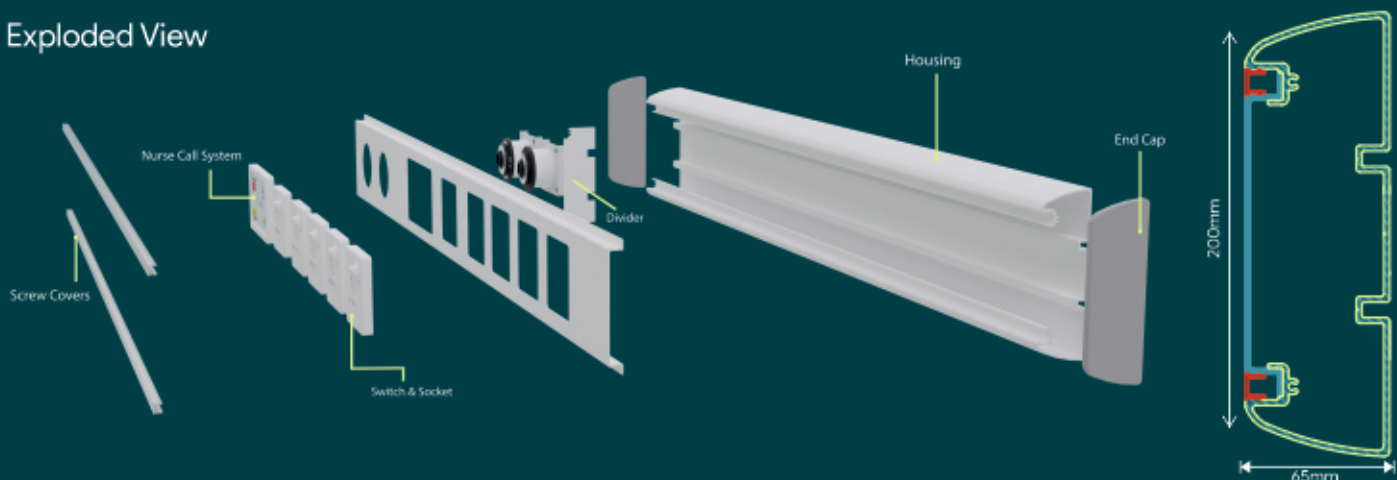

# Bed Head Panels

## Aura

The "Aura" series is a versatile bed head panel designed for healthcare settings. It features dual light housings: indirect lighting to illuminate the room and direct lighting for patient use such as reading. Offering both horizontal and vertical use, it prioritizes essential functionalities like medical equipment provisions, power outlets, and other crucial elements for effective patient care.



### Bed Head Panel Configuration:

- Material: Extruded Aluminum Alloy (T6 – 6063)
- Dimensions: Length – Customizable  
Width – 260mm, Depth – 65mm.
- Standard Length: 1000mm, 1200mm, 1500, 1800mm & 2000mm.
- Orientation: Horizontal or Vertical.**

### Features

- Impact Resistant Aluminum End Caps.
- Disinfection & Corrosion Resistant.
- Option for Indirect Led Light & Reading Light.**

### Exploded View

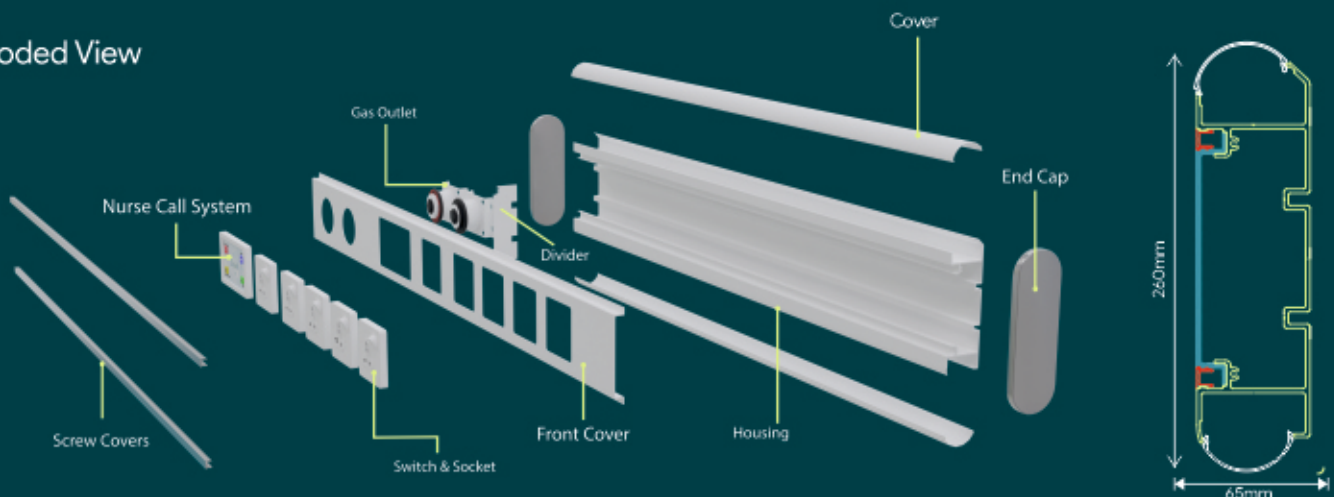



# Bed Head Panels

## Camo

“Camo” series is our wall recessed bed head panel designed in a way to give a surface finish look to an aesthetically designed patient room. The modular design offers the option of having an unobtrusive finishing on the wall.



### Bed Head Panel Configuration:

- Material: Extruded Aluminum Alloy (T6 – 6063)
- Dimensions: Length – Customizable  
Width – 225mm, Depth–65mm.
- Standard Length: 1000mm, 1200mm, 1500, 1800mm & 2000mm.
- Orientation: Horizontal or Vertical.

### Features

- Impact Resistant Aluminum End Caps.
- Disinfection & Corrosion Resistant.
- Recessed / Concealed Wall Mounted

### Exploded View

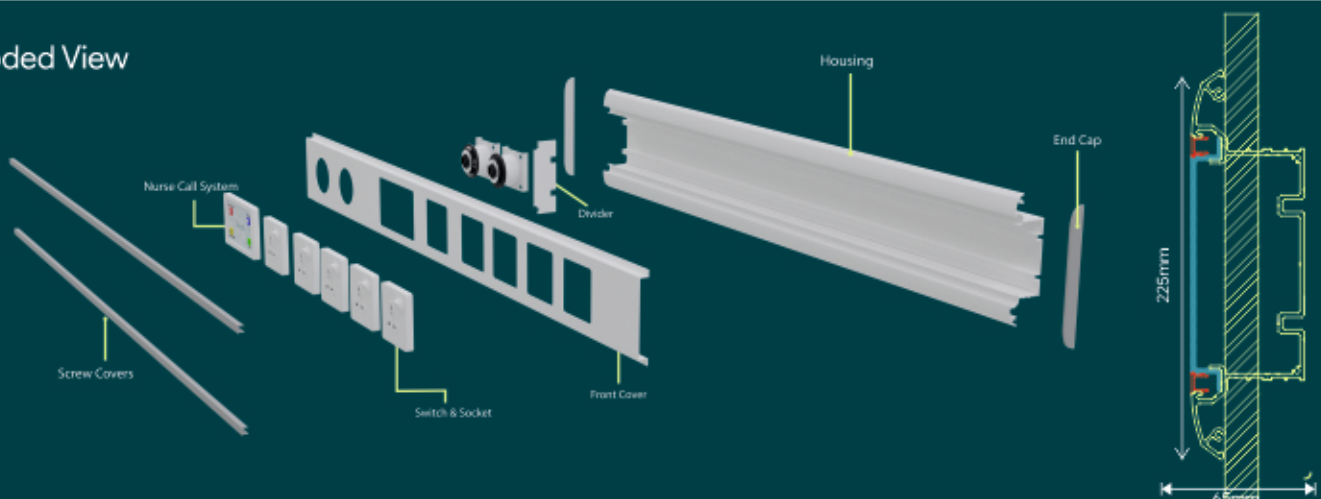

# Bed Head Panels

## Magnus

The "Magnus" healthcare bed head panel features dual light housings for room and patient-focused activities, separate compartments for electrical and medical gas pipelines, and provisions for essential medical equipment and power outlets, optimizing patient care.

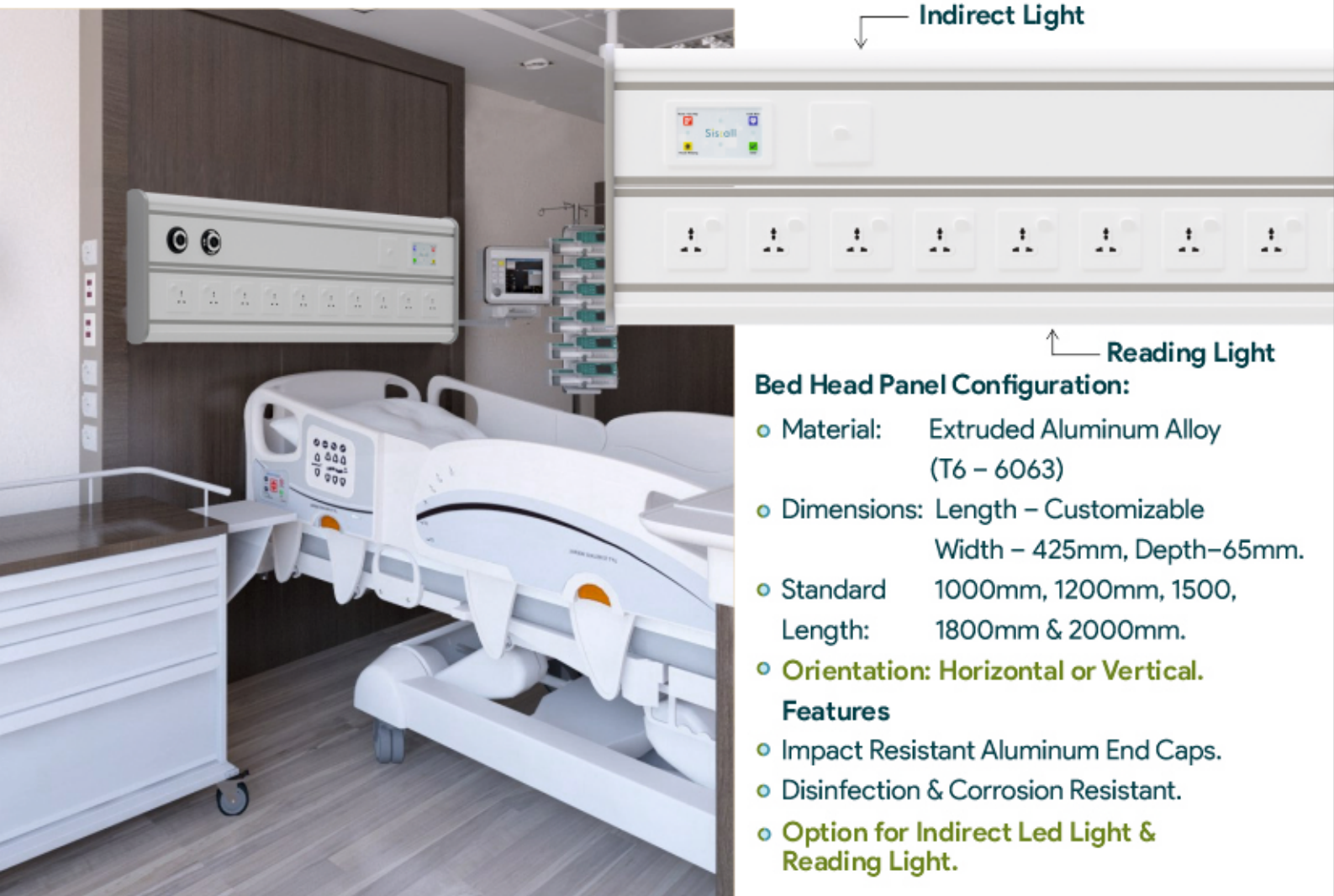

### Bed Head Panel Configuration:

- Material: Extruded Aluminum Alloy (T6 – 6063)
- Dimensions: Length – Customizable  
Width – 425mm, Depth–65mm.
- Standard Length: 1000mm, 1200mm, 1500, 1800mm & 2000mm.
- Orientation: Horizontal or Vertical.

### Features

- Impact Resistant Aluminum End Caps.
- Disinfection & Corrosion Resistant.
- Option for Indirect Led Light & Reading Light.

### Exploded View

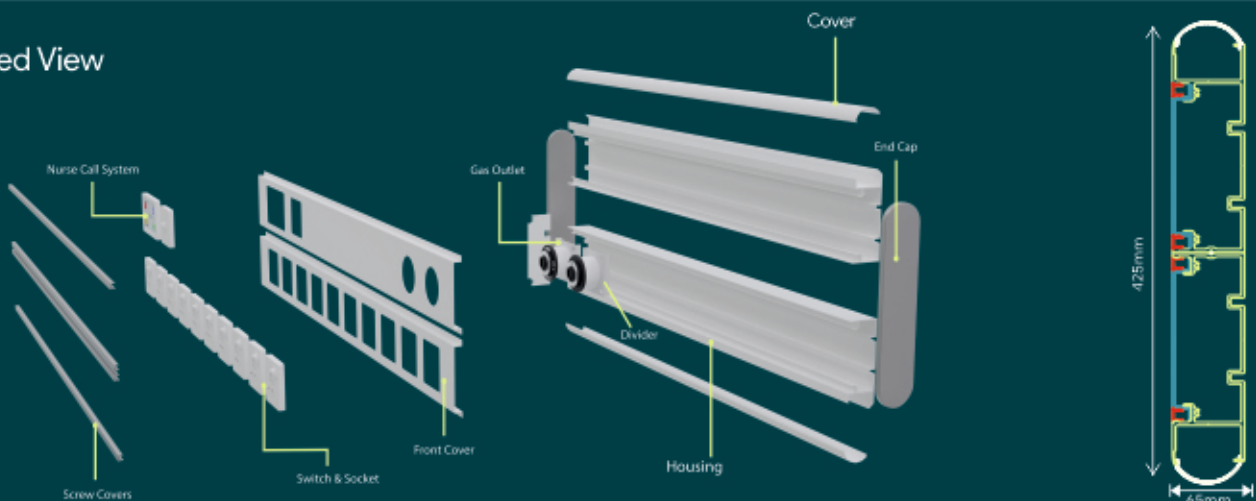



# Bed Head Panels

## Colour Range

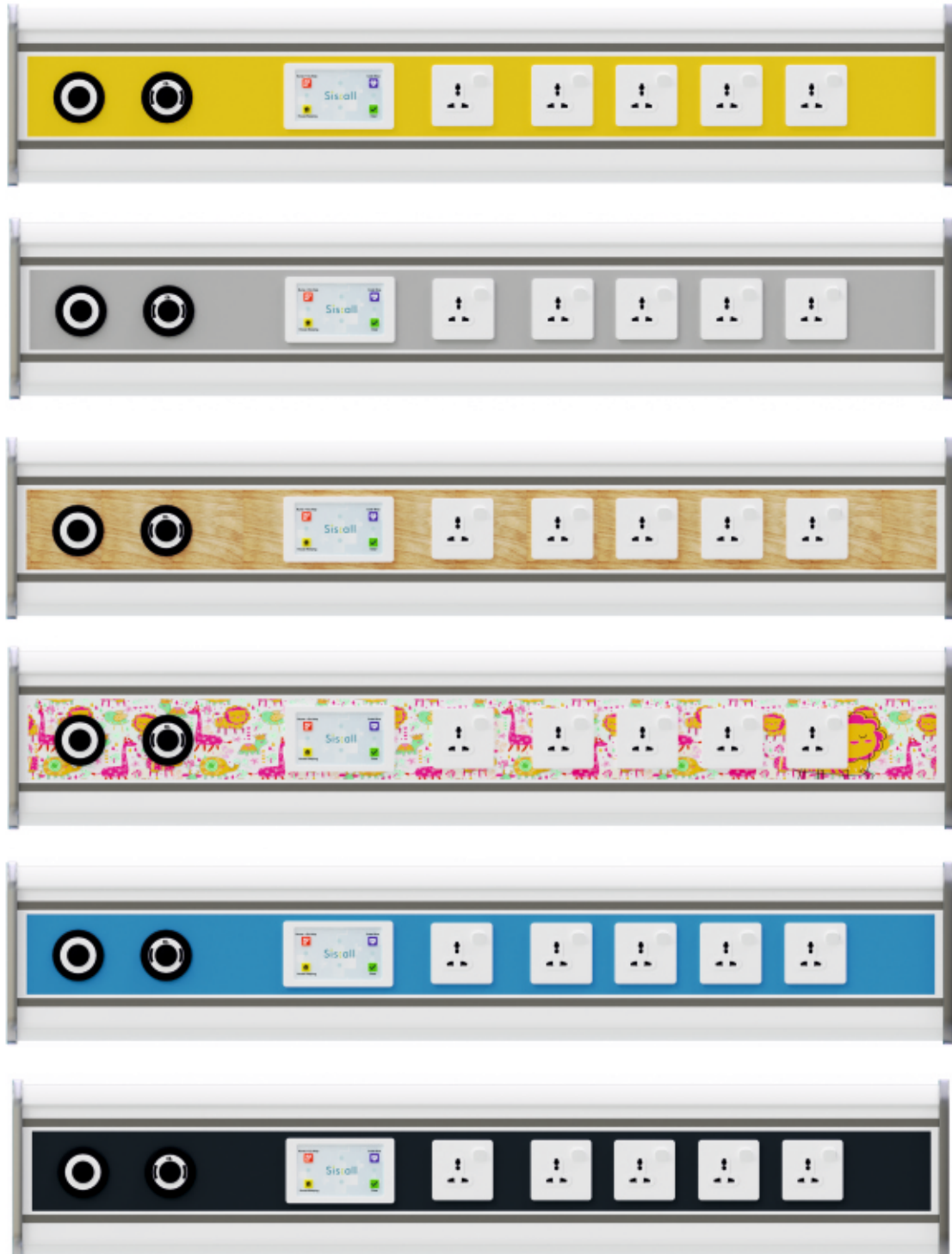

Available in Different RAL Colours, Wood Finish, & Image Printing

## Wall Unit:

Wall unit serves as a centralized communication system, enabling patients and staff to request assistance, report emergencies, and acknowledge patient-related information. The salient features of our wall unit are as follows.



### 01 Five Functional Buttons and LED Indicators:

- **Nurse Call:** Indicated a general call for nurse.
- **Code Blue:** Typically used for medical emergencies or cardiac arrest situations.
- **Extra Help:** Likely used for situations where additional assistance is required.
- **Housekeeping:** Possibly used to request housekeeping services.
- **Clear Function:** This button allows the nursing staff to clear all active calls placed from a wall unit also making sure that a nursing staff has attended the call.

### 02 Audio and Visual Indicators for Call Registration:

- This feature is an indicator that when a call button is pressed there will be both sound and light signals confirming that a call has been placed.

### 03 Acknowledge LED Indication for Patient Evidence:

- This feature on our wall unit suggests that whenever a patient has registered a call and that call has been acknowledged by the nursing staff from their end and indicator on the wall unit will tell the patient that their call has been seen and acknowledged and that someone will soon be there to address their problem.

### 04 Concealed or Surface Mount Options:

- This gives flexibility in installation, allowing the unit to be either recessed into the wall or bed head panels or mounted on the surface of the wall.

## Patient Remote:

Patient Remote serves as a valuable tool for patients, empowering them to communicate their needs to healthcare staff efficiently. The simplicity of two functional buttons and a LED indicator contributes to a user-friendly experience, and the ergonomic design ensures that patients can easily handle and interact with the remote.



### 01 Two Functional Buttons & LED Indicator:

- **Nurse Call Button:** This button will be used by patients to request assistance from nursing staff
- **Housekeeping Call Button:** This button will be used by patients to request assistance from housekeeping staff.
- The LED indicator on the remote will provide a visual feedback to the patient confirming that their request has been registered.

### 02 Ergonomic Design for Ease of Use:

- The device has been designed keeping the user's comfort and ease of use in mind. This is especially important in healthcare settings where patients may have varying physical abilities and health conditions. Ergonomic design ensures that the remote is user friendly, making it accessible to a broad range of patients.

## Toilet Call Unit:

Toilet Call system is designed to address emergency situations in toilet areas. The pull cord is a critical feature, offering a quick and accessible means for users to signal for help. The additional Nurse Calling button suggests that the system can be used for both emergency and non-emergency situations.



### 01 Toilet Emergency Alert Unit:

- This unit is installed in or near a toilet area to allow individuals to call for assistance in case of emergencies or urgent needs.

### 02 Pull Cord of 2 Meter Length:

- The pull cord is a mechanism that individuals can use to activate the emergency alert. The 2-meter length implies that it can be easily reached and pulled from various positions within the toilet area.

### ➤ Nurse Calling Button:

- This button is an additional feature that allows the user to call for nursing assistance. It might be for non-emergency situations where the user requires help but not necessarily immediate or urgent attention.

### ➤ Clear Functional Button:

- This button likely serves the purpose of clearing or canceling an active alert. After the situation has been addressed, the user or the healthcare staff can press this button to indicate that the alert is no longer needed.



## Door Light:

Our Door Light Indicator system is a comprehensive and visually intuitive solution for communication and status indication in a healthcare environment. The bright 6 color-coded system enhances clarity and minimizes confusion in critical situations.

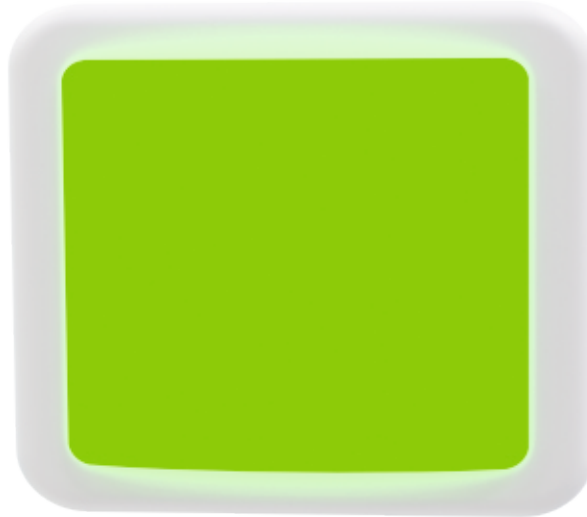

### 01 Door Light LED Indicator :







The LED lights are designed to be bright, ensuring visibility even in well-lit environments. The use of multiple colors allows for clear differentiation between different types of alerts or status indications.

Each LED indicator corresponds to a specific type of call or room status. This provides a quick and clear visual reference for both staff and patients/residents.

The system appears to be designed to operate without requiring a separate power source, possibly drawing power from the main system it is integrated with. This can simplify installation and reduce the need for additional wiring.

The color-coding system is intuitive and can be quickly understood by both staff and patients. This simplifies the process of identifying the nature of the call or room status without the need for additional interpretation.

#### Color Coding Defaults:

- |   |   |   |
|---|---|---|
|  |  |  |
| 1.Red: Nurse Call   | 2.Red Blinking: Extra Help Needed   | 3.Blue: Code Blue (emergency)   |
|  |  |  |
| 4.Yellow: Housekeeping  | 5.Purple: Toilet Call   | 6.Green: Room Occupied  |
|  |   |   |
| 7.White: Room Vacant  |   |   |

# SisCall - Nurse Call System

## Nursing Station Display:

The Nurse Station is a critical component of our Nurse Call System, designed to help nurses manage patient calls and monitor their status with ease. Here are some of the key features of our Nurse Station

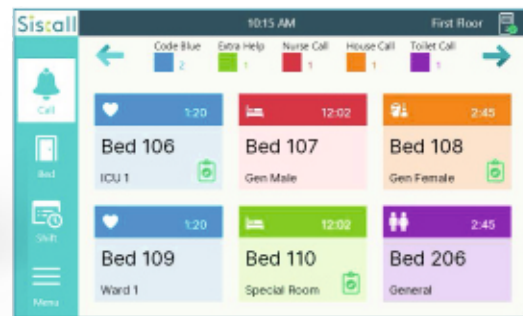

- 01 **10" Touch Screen Color Display:** The 10-inch touch screen display is easy to read and provides a central hub for managing patient calls. Nurses can quickly and easily view call type, room name, and bed number, making it easy to respond to patient needs.
- 02 **Touch Button for Call Acknowledgment:** The touch button allows nurses to acknowledge patient calls with ease, ensuring that patients know that their call has been received and that help is on the way.
- 03 **Our uniquely designed system also allows the user to choose from multiple display options like our 10" Inch Touchscreen Display, A regular Computer Monitor or a HDMI LED TV (Upto 32" Inches)**
- 04 **Color Coded Display:** The color-coded display allows nurses to quickly identify the type of call, making it easy to prioritize and respond to patient needs.
- 05 **High Quality Voice Announcement:** The Nurse Station features high-quality voice announcements that narrate the type of call, making it easy for nurses to understand the patient's needs.
- 06 **Active Call Timer with Active Call Reminder:** The active call timer and reminder ensure that patients are never left waiting for assistance, and that nurses can respond to patient needs promptly.
- 07 **Fault Detection:** The on-screen system error message ensures that any faults are quickly identified and addressed, ensuring that the system is always running smoothly.

## SisCall Software and App

SisCall Software and App offer a comprehensive solution for efficient call management in healthcare settings, providing a range of features to enhance workflow and patient care. SisCall Software and app are designed to enhance efficiency, communication and overall patient care within healthcare institutions.



### Salient Features:

- 01 **Total Calls Overview:** Easily monitor the total number of calls, categorized for better insights into patient needs.
- 02 **Shift Wise Call Logs:** Access detailed call logs organized by shifts, ensuring a clear understanding of activity trends during different periods.
- 03 **Station Wise Nurse Call Logs:** View nurse call logs specific to each station, facilitating targeted responses and improved coordination.
- 04 **High Frequency Calls with Bed Wise Indicators:** Identify high-frequency calls, complete with bed-wise indicators highlighting the originating bed number or ward for quick prioritization.
- 05 **Busy Hours Analysis:** Determine the busiest hours by analyzing which nursing display receives the maximum calls, aiding in optimized staffing and resource allocation.
- 06 **Reminder Feature:** Empower nursing staff with the ability to set patient-specific reminders for particular wards or bed numbers, ensuring timely and personalized care.
- 07 **Analytics Feature:** Generate detailed reports with various periodic options, offering hospital administrators and head nursing staff valuable insights into call patterns and performance.
- 08 **Broadcast Feature:** Streamline communication by enabling hospital administrators or head nursing staff to broadcast announcements across the nursing staff, eliminating the need for individual addresses.
- 09 **Bird View Feature:** Ensure connectivity by utilizing the Bird-view feature, allowing staff to identify the status of wall units and door lights. Disconnected units are clearly indicated



# SisCall - Nurse Call System

## Key Features

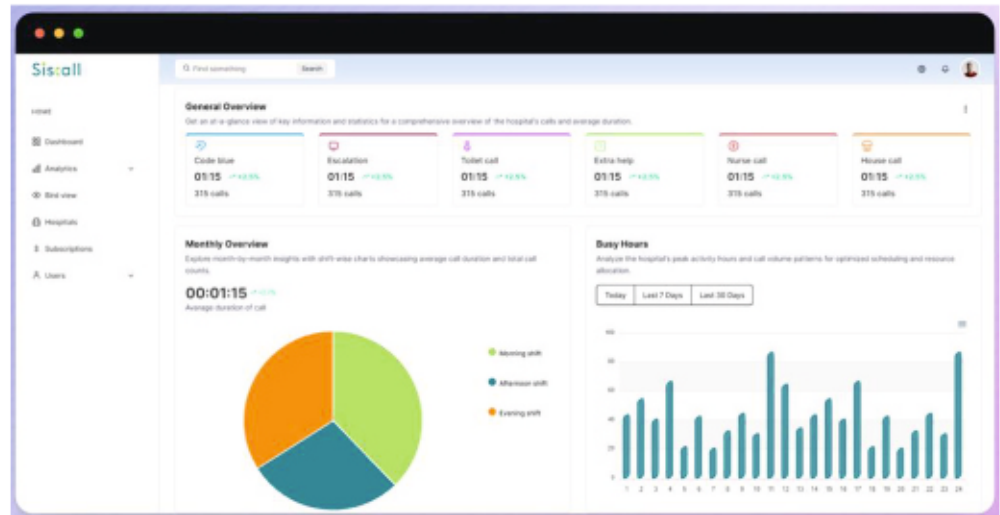
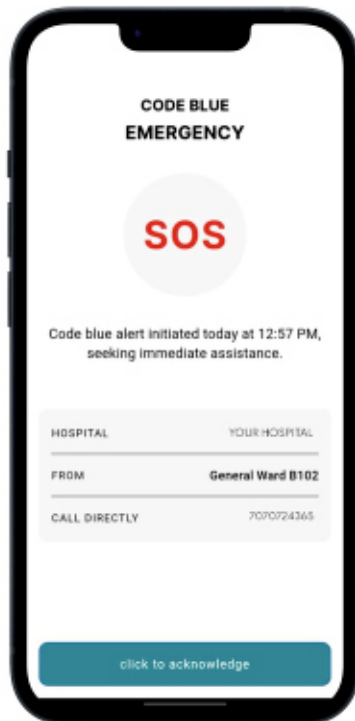

- 01 Call Forwarding:** When activated, this feature directs all incoming calls to a nurse station to the next assigned station if not answered within the specified turnaround time (TAT).
- 02 Call Escalation:** Designed to optimize nursing staff utilization, this feature redirects calls from low patient occupancy areas to the nearest assigned nurse station, ensuring efficient response and coverage.
- 03 Loop Protection:** Our systematic cabling solution offers loop protection, safeguarding against cable malfunctions. In the event of a cut cable, power and data seamlessly reroute through an alternative path, preventing system downtime.
- 04 Central Monitoring:** Empowering Healthcare Administrators and Head of Nursing staff, this feature enables centralized monitoring of all nurse call system activities from a desktop. The "Live View" feature provides real-time visibility into active calls at specific nursing stations, streamlining oversight and ensuring timely responses to maintain high-quality healthcare services.
- 05 SOS ALERT:** Integrated into our app, this functionality notifies assigned emergency staff and doctors with a "SOS ALERT" on their mobile devices when a code blue call is activated. This swift notification ensures immediate action in emergency scenarios, enhancing response times and patient care.



# SisCall-Nurse Call System

## System Architecture

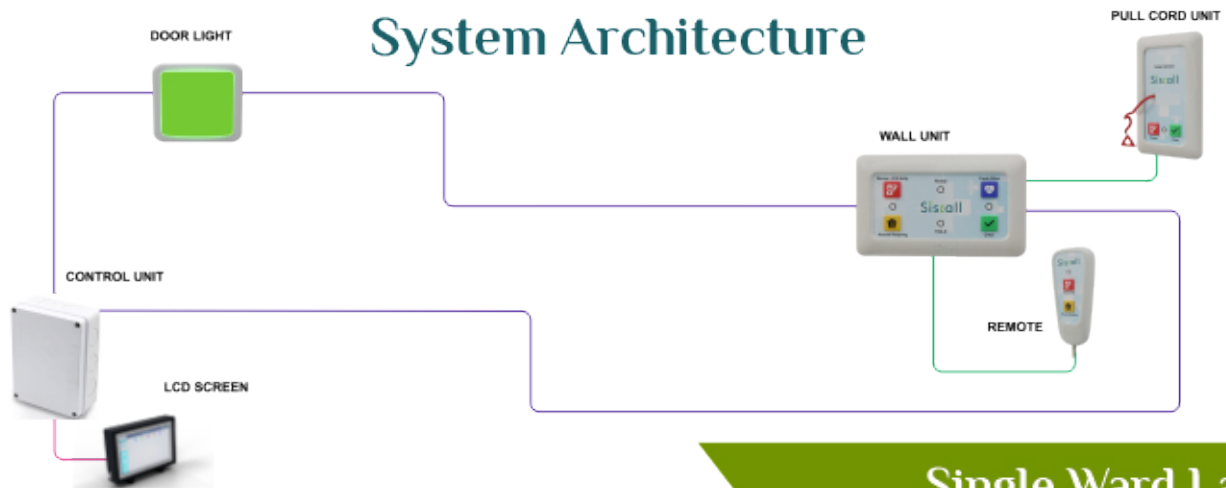

Single Ward Layout

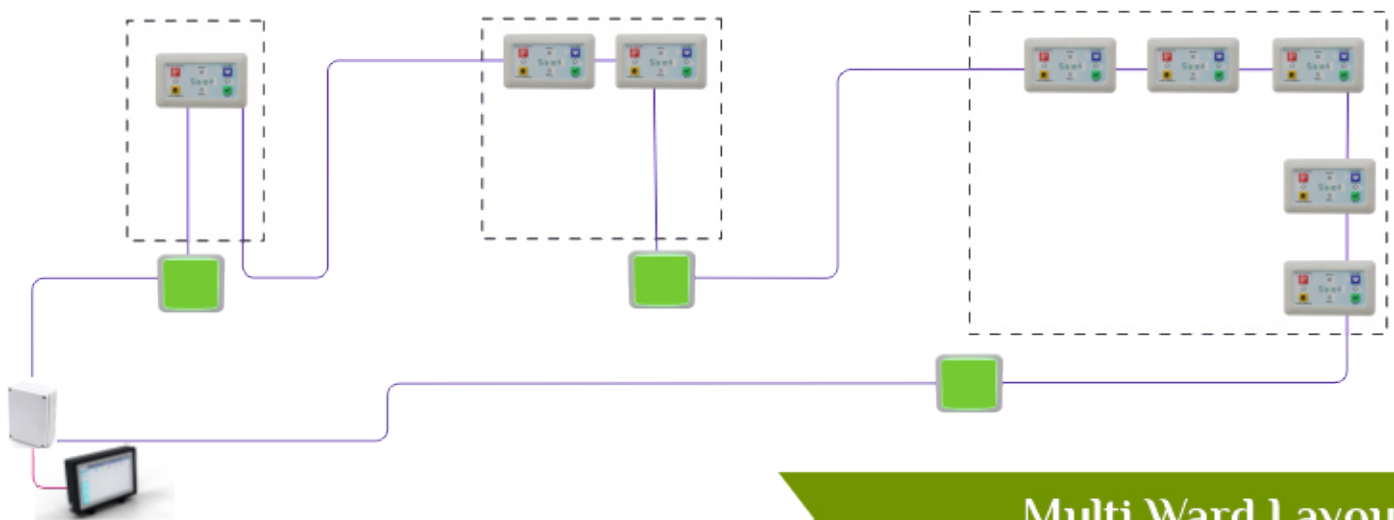

Multi Ward Layout

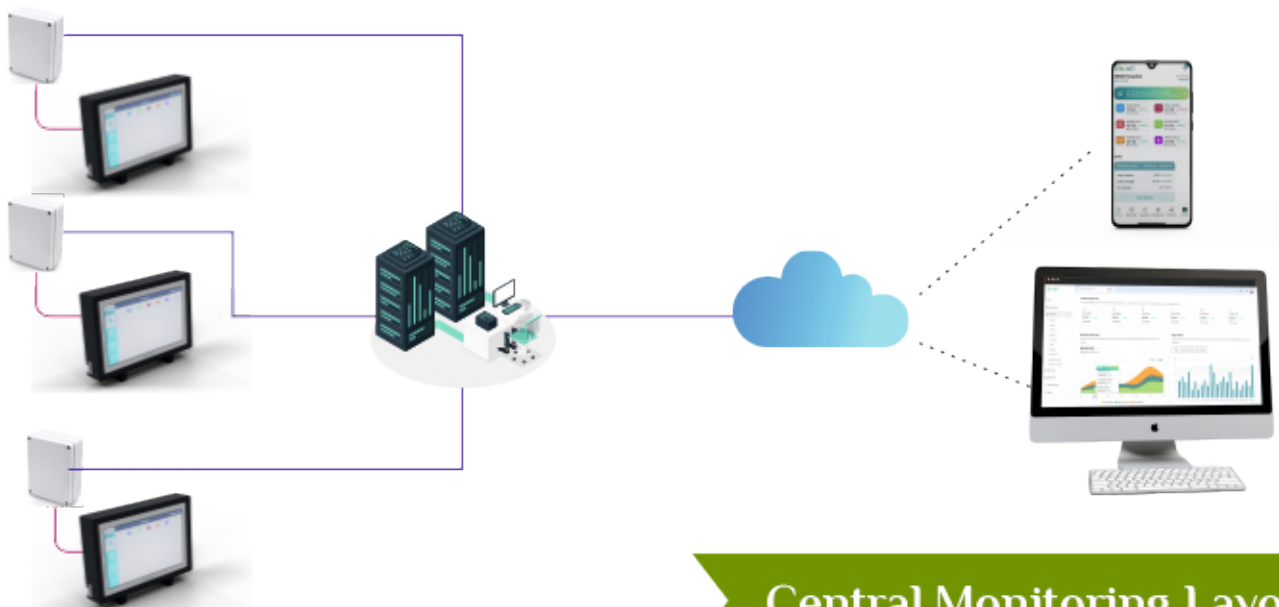

Central Monitoring Layout

# Cubicle Hospital Tracks

“i-Traack™,”

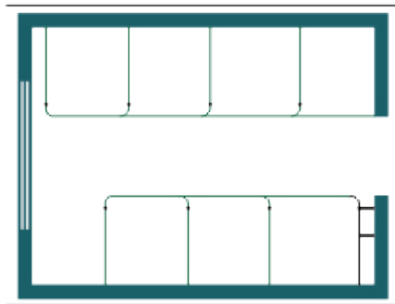

Typical Methods  
of Installation

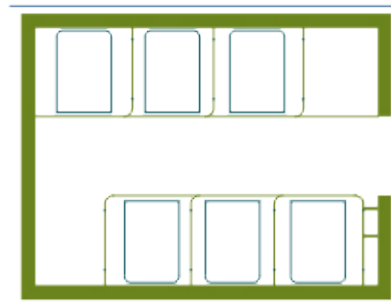

Typical Layout  
Hospitals/ Clinics

Combining mechanical strength of heavy Aluminium Alloy and smart designing process, you are assured with smoothest, safest, strongest performance of our hospital cubicle track systems. These features & the demand of our track have increased our acceptability at various major hospitals all over India.

- “i-Traack™” Cubicle Track System is made of High Quality Aluminium Alloy.
- Medically Approved White Powder Coated with Anti - Bacterial Finish (Standard)
- “i-Traack™” is long-lasting, highly stable, durable and LOW COST.
- It's slim, stronger and yet elegant in look.

# Cubicle Hospital Curtains

## Urban Fresh™

Anti-Microbial, Anti-Fungal & Water Repellent Hospital Curtains



"Urban Fresh™" is a durable Antimicrobial, Anti Fungal curtains that provides lasting freshness, stain protection and extended product life by controlling growth of unwanted microbes that cause odors, staining and product degradation.

## Benefits of "Urban Fresh™" Curtains

- High Performance - Prevents staining and degradation caused by bacteria, mold and mildew.
- Freshness - Works continuously to control unpleasant microbial odour.
- Hygienic - Keeps products fresh and odour-free.
- Sustainable - Durable to multiple washes.(upto 50 washes)\*
- Safe, Extremely Effective and Very Economical.
- We provide upon request a certification in the name of your Hospital which is accredited by a world-renowned laboratory, holds global acceptance.



# Cubicle Hospital Curtains

## Urban Safe™

### Fire Retardant & Anti-Microbial Hospital Curtains

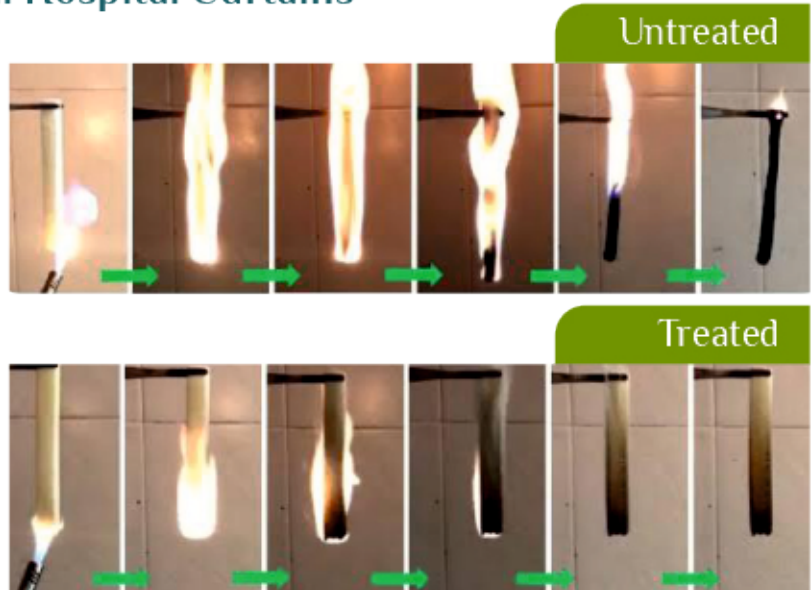

"Urban Safe™" is durable Fire Retardant & Antimicrobial curtains that provides fire protection, lasting freshness and extended product life by controlling growth of unwanted microbes that cause odours, staining and product degradation.

## Benefits of "Urban Safe™" Curtains

- Reduces the toxic smoke and fumes.
- Proven to meet International Fire Retardant Standards.
- We meet and maintain USA Canada and European Fire Retardant Standards.
- **Sustainable** - Durable to multiple washes. (up-to 25 washes)\*
- Extremely Effective and Very Economical.
- We provide upon request a certification in the name of your Hospital which is accredited by a world-renowned laboratory, holds global acceptance.



# “Wall Shield” - Wall Protection

## Why “Wall Shield?”

Shield your interior spaces from the inevitable wear and tear of daily foot traffic. Avoid the burden of constant and expensive maintenance caused by scratches, dents, and scrapes on your walls. Enhance both the aesthetic appeal and durability of your interiors by opting for our diverse range of “Wall Shield” wall protection solutions. Our offerings provide a stylish appearance while ensuring the safeguarding you require, striking the perfect balance between the look you desire and the maintenance protection you need.

### Wall Guard WSW – 150



- Rigid Vinyl Cover - 2mm thickness
- Aluminum Retainer - 2mm thickness
- PVC Impact Protection Strip
- ABS End Caps



Sr.No	Parameter	Materials Details.
1	Available Lengths	Standard 12 feet
2	Materials	Aluminum and Rigid Vinyl
3	Areas of Use	Hallways, Corridors, Areas with high equipment movement
4	Dimensions	Height – 102mm & 152mm, Depth – 25mm
5	Available Colors	Standard Solid Colors

### Wall Guard WSW – 100

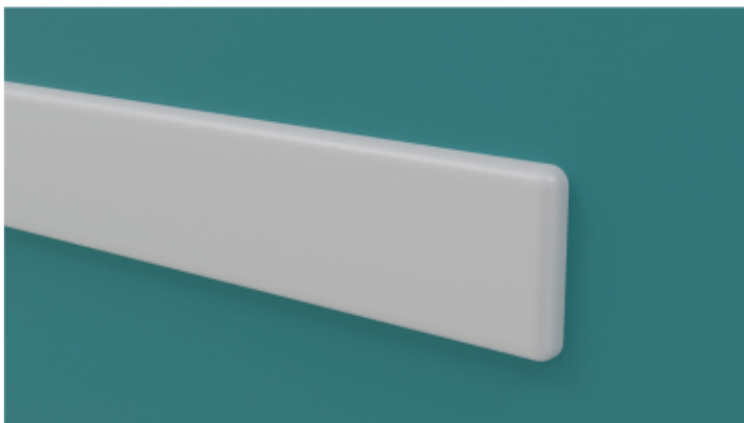

- Rigid Vinyl Cover - 2mm thickness
- Aluminum Retainer - 2mm thickness
- PVC Impact Protection Strip
- ABS End Caps

# “Wall Shield” - Wall Protection

## Hand Rail WSH – 900



- Rigid Vinyl Cover - 2mm thickness
- Aluminum Retainer - 2mm thickness
- Mounting Bracket
- ABS End Caps



Sr.No	Parameter	Materials Details.
1	Available Lengths	Standard 12 feet
2	Materials	Aluminum and Rigid Vinyl
3	Areas of Use	Hallways, Corridors, Areas for Patient Movement and Rehabilitation
4	Dimensions	Height – 92mm & 140mm, Depth – 38mm & 76mm
5	Available Colors	Standard Solid Colors

## Corner Guard WSC – 050



- Rigid Vinyl Cover - 2mm thickness
- Aluminum Retainer - 2mm thickness
- ABS End Caps

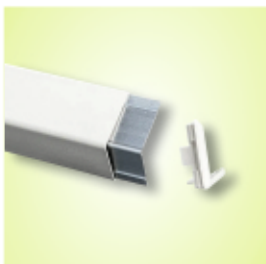

Sr.No	Parameter	Materials Details.
1	Available Lengths	Standard 12 feet
2	Materials	Aluminum and Rigid Vinyl
3	Areas of Use	Hallways, Corridors, Areas with high equipment movement
4	Dimensions	Wing Span – 52mm
5	Available Colors	Standard Solid Colors

# “Wall Shield” - Wall Protection

## Hand Rail WSH – 800



- Rigid Vinyl Cover - 2mm thickness
- Aluminum Retainer - 2mm thickness
- Mounting Bracket
- ABS End Caps

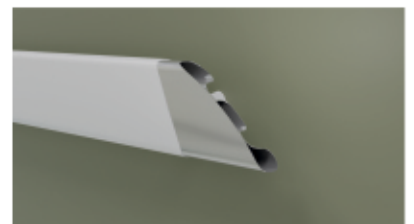
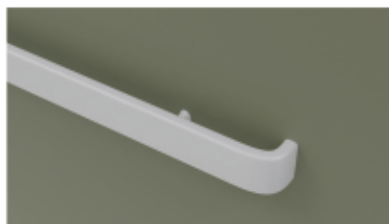



# Pneumatic Tube System

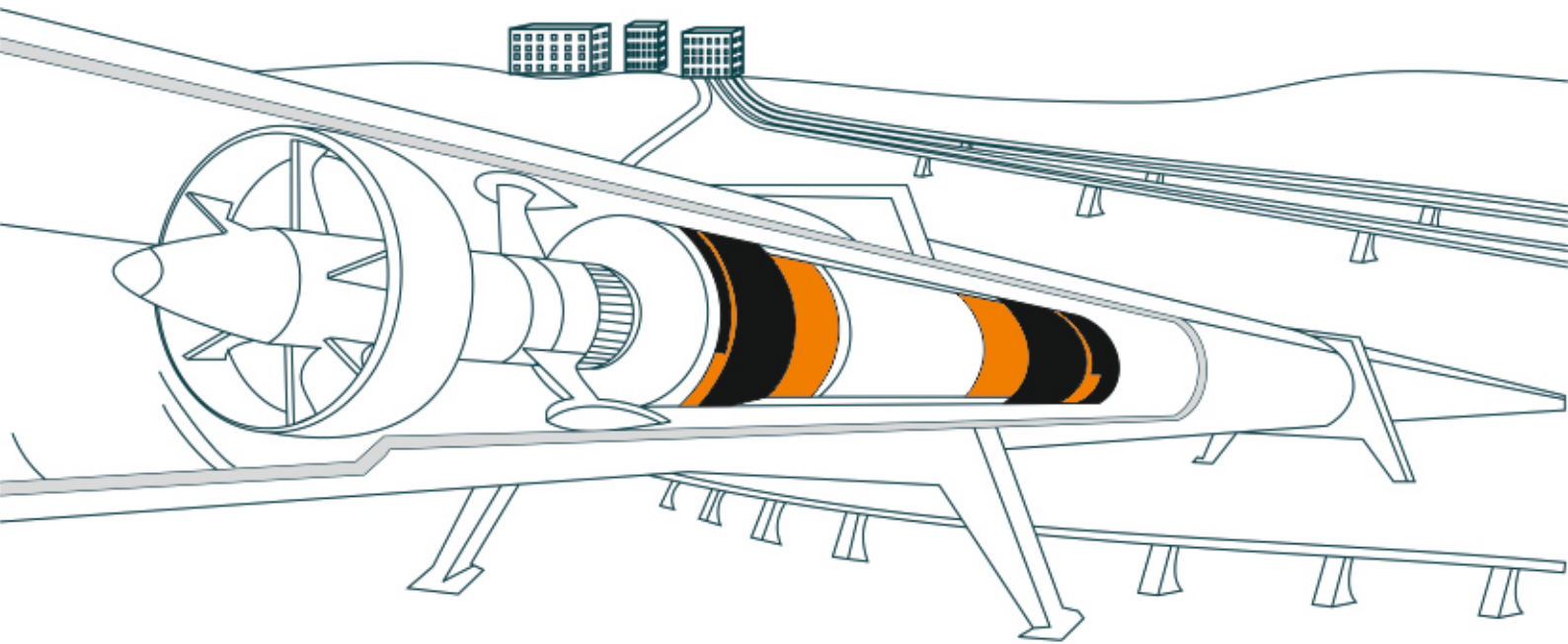



# Pneumatic Tube System

## WHY A PNEUMATIC TUBE SYSTEM?

Optimizes internal logistics without worries...

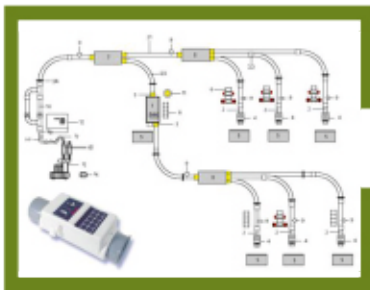

PNEUMATIC TUBE SYSTEM

### ➤ Why Pneumatic tube System?

The pneumatic tube systems solve the problems of internal movement, with a displacement speed of 5-8 m/s. the pneumatic tube system saves time and energy and allows your staff to concentrate on more important tasks.

### ➤ When is the right time to decide to install a pneumatic tube system?

PTS Automation supplies pneumatic tube systems for companies of all size, from 2 points systems to multi zone systems. Which can have up to 9999 interconnected stations. You can perform installations both in already existing buildings and under construction one.

### ➤ What can be transported with pneumatic tube systems?

You can carry almost anything from sample weighing 1 gram up to articles 3 kg. from articles with a maximum diameter of 114 mm up to those with a maximum length of 330 mm. In these categories you can find a large amount of transportable things: **Medical Records, Billing Documents, X-Rays, Medication, Lab Specimens, Blood, Plasma, Injection Vials, Urine Samples etc...**

### ➤ Where to install a pneumatic tube system?

Virtually everywhere. There are systems developed horizontally and other vertically and not always in the same building. There are pneumatic tube system that connect buildings that are far from one another.

# Pneumatic Tube System

## Our Products



### Carriers

(Applicable for OD110 & OD160)

- Wide end velcro rings for smooth travel
- Transparent body
- Designed under Right to Repair
- Easy to handle, Fall proof
- Spring loaded flap and swivel Cap
- Robust and light weight
- Easy to replace end Velcro rings
- Available in customized color on request
- RFID capability
- Carrier accessories
- Soft Cloth Pouch
- Foam Inserts



### Blower

- Unidirectional Motor Rotation
- Wide range of power capability(2.3Kw to 6.3Kw)
- Suction and Pressure range 200mbar 350mbar
- Customization of speed for all sending transaction

#### Blower accessories

- Air Diverter to Change Air Flow on the Fly
- Variable Frequency Drive
- Mounting Accessories
- Silencer, Air Filter, Etc



### Diverter

- State of art servo motors for accurate hole position
- Photo-electric sensor to check carrier passed status
- possible in 2-way, 3-way and 4-way variants
- It can be ceiling/wall mount or ceiling hanging
- It be used to Make Zone Exchanger

# Pneumatic Tube System

## Station Applicable

### End Type Station



- Load Carrier on bottom area of station
- Only Top Pipe Connection
- Send and Receive Capability
- Carrier in Queue
- Install at Bottom Plate 1.0m – 1.1m from finished floor

### Top Pass-Through Type Station



- Load Carrier on top part of station
- Top and Bottom Bi-direction connection
- Carrier in Queuing is possible
- Top Plate 1.5m – 1.6m from finished floor

### Bottom Pass-Through Type Station



- Load Carrier on bottom area of station
- Top and Bottom Bi-direction connection
- Only applicable when blower connected on Top Pipe
- Install at Bottom Plate 1.0m – 1.1m from finished floor

### Multi Send Station



- Only Send Operation
- Multiple destination screen
- Works for high sending load

### Lab Station

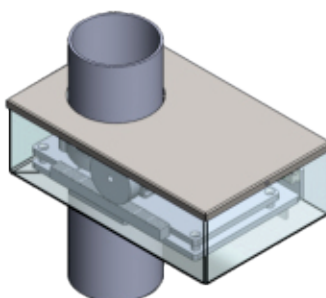

- Only Receive Operation
- It can receive train of carrier
- Slider lock to receive smoothly
- Recommended for high receiving load
- Rail or receiving table (Optional)



hhincindia



📍 G-315, Udhana Udhyanagar Commercial Complex, Opp. Bank Of Baroda,  
Beside Prime Bank, Road No. 10, Udhana, Surat, Guj., India. Pin - 394210.

👤 Customer Care +91 70707 24365 🌐 [www.hhinc.in](http://www.hhinc.in) ✉ [info@hhinc.in](mailto:info@hhinc.in)